



## Dolls made from clothes pegs

v15705

Make your own small dolls from vintage clothes pegs with a wooden base. Decorate the clothes pegs with craft paint, marker pens, pipe cleaners and felt to create different expressions.

### Comment faire



**1** Adjust the length of the clothes pegs by marking with a line on the various clothes pegs and saw off the ends. For this idea we have sawn off to these lengths: Dad: full size Mum: saw off 0.7 cm Girl: saw off 2.7 cm Baby: saw off 4.5 cm



**2** Draw the faces onto the vintage clothes pegs using Colortime Fineline markers. Use a small brush and craft paint for the hair. Paint two small wooden beads for the girls' bun and attach with hobby glue. When the mum's hair is dry, paint a grey head band using craft paint. When the head band is dry, decorate further with small dots made with white craft paint.

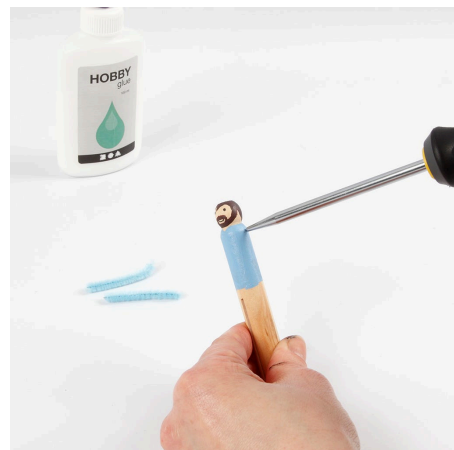

**3** Make the Dad by painting the top of the clothes peg with blue craft paint. Paint a black tie once the blue paint is dry. Paint the bottom of the clothes peg and the stand with black craft paint and leave to dry. Use an awl for pushing a hole into each side for the arms. Apply a bit of glue to one end of two pieces of blue pipe cleaner and push into each hole.





**4** Cut a piece of black felt for the Dad's trousers using the template which is available as a separate PDF file on this page. Make a diagonal cut in the middle of the black piece of felt to divide the trouser legs. Attach power tape along all edges and attach the trousers onto the clothes peg. The joint should be at the back.

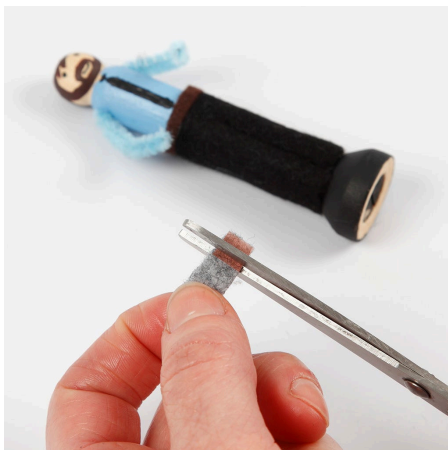

**5** Use the template to make a belt from a piece of brown felt using the template. Attach power tape first as this enables you to hold onto the felt when cutting it into a narrow strip for the belt. Use the same procedure when cutting a small belt buckle from grey felt and attach this onto the belt.

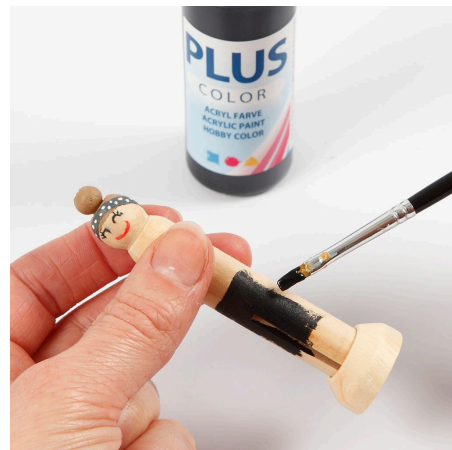

**6** Make the Mum by painting the legs and the stand with black craft paint.

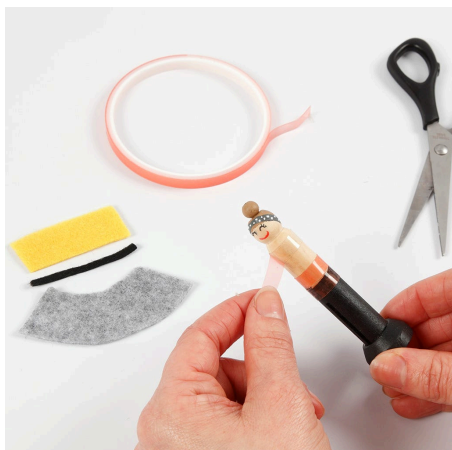

**7** Cut out the blouse, the skirt and the belt using the template. Attach power tape onto the clothes or onto the clothes peg as shown in the photo.



**8** Attach the clothes onto the clothes peg. Attach a piece of power tape onto the skirt for fastening at the back.



**9** Use an awl for making a hole on each side for the arms. Apply a bit of glue to one end of two pieces of yellow pipe cleaner and push into each hole.



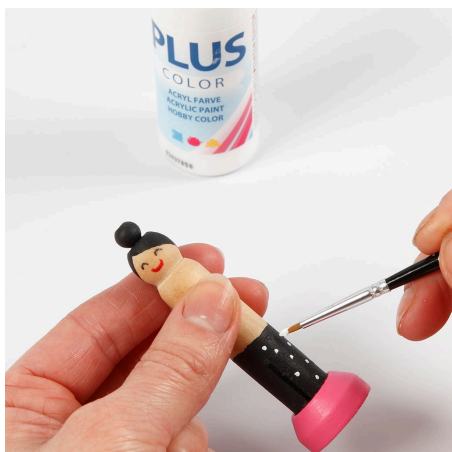

**10** Make the daughter by painting the base of the clothes peg with black craft paint and the stand with pink craft paint. When the paint is dry, paint small white dots on the black legs.



**11** Cut out the dress using the template. Attach power tape onto the dress and attach the dress onto the girl.

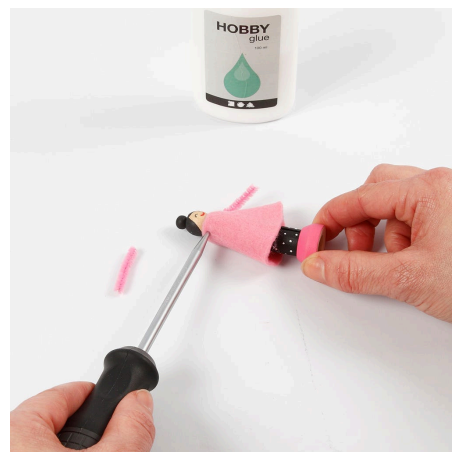

**12** Use an awl for making a hole on each side for the arms. Apply a bit of glue to one end of two pieces of pink pipe cleaner and push into each hole.



**13** Cut out a small bow from white felt and attach it onto the dress with hobby glue.



**14** Make the baby by cutting out a bonnet from pink felt using the template and cut out a blanket from pale blue felt using the template. Attach power tape along all the edges and attach the felt onto the baby.

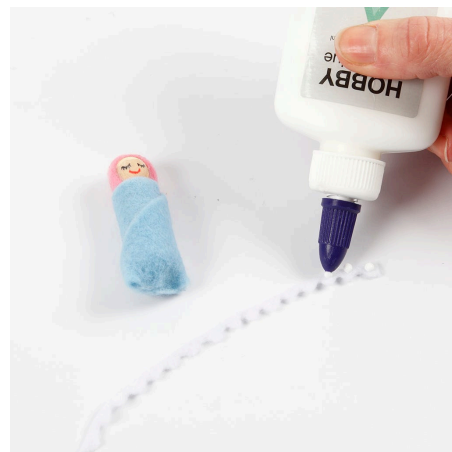

**15** Cut out a decorative border for the blanket from white felt using the template.



**16** Attach the border onto the edge of the blanket using hobby glue.



