



Crepe paper mistletoe

v15978

This crepe paper mistletoe is made with glitter berries and is gathered with a red glitter ribbon tied in a bow.

Hoe werkt het



1 Print and cut out the template which is available as a PDF file at the bottom. You can make the mistletoe as large or as small as you wish. We have used 35 leaves for this mistletoe. Remember to cut according to the stretch direction shown on the template. Also cut 1 x 20 cm strips of crepe paper for covering the "branches" - here we have cut three long strips of crepe paper.



2 Round each leaf by pulling the petal between a bone folder and your thumb (the same technique as curling a ribbon with scissors).



3 Shape the leaf by stretching the middle of it, so that it becomes round. Repeat the procedure described in steps 2 and 3 with all the leaves.





4 Start by attaching two leaves onto one of the pointed ends of a thin floral stem wire. Use a glue gun at a low temperature setting for the best result.

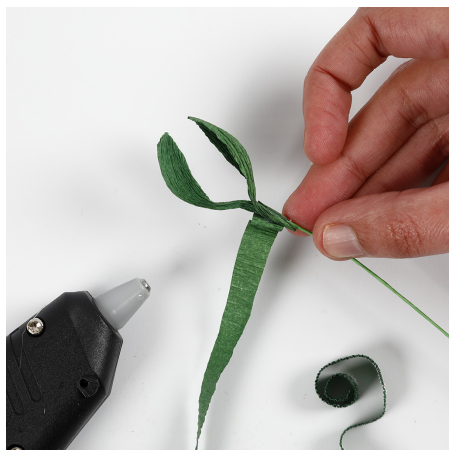

5 Cover the floral stem wire with crepe paper once the leaves are glued on. Attach the end of the crepe paper strip on top of the leaves (where they are glued onto the floral stem wire).



6 Stretch out the long thin piece of green crepe paper (to flatten it) and cover the floral stem wire by wrapping the crepe paper at an angle around it, securing with Multi Glue as you go along. Stop after approx. 5 cm.



7 Here you can see the stem with the top 5 cm covered by the green crepe paper as well as berries on floral stem wires covered with green crepe paper strips. Furthermore, this photo illustrates a floral stem wire with two leaves at one end. These (the berries and the floral stem wire with two leaves) are to be wrapped with the finished main floral stem wire.



8 Continue wrapping the green crepe paper strip onto the floral stem wire and attach another green leaf with a glue gun. The joint is covered by continuing wrapping the strip of green crepe paper onto the floral stem wire. Continue in this fashion.



9 A bit further along, attach the floral stem wires with the white berries onto the main floral stem wire. Twist these onto the main floral stem wire you are working on, "hiding" the wires of the berries by continuing to wrap the green crepe paper strip around the main floral stem wire.



10 Attach the branch with the two leaves onto the floral stem wire the same way as attaching the berries.



11 Continue attaching leaves and berries moving towards the other end of the floral stem wire until you have your chosen length and look.



12 Make your chosen number of branches. Four branches have been used here for making this mistletoe.





13

Tie the branches together with a ribbon in a bow. To make it more secure, you may tie the branches together with a floral stem wire which can then be covered by the bow.



Template

Print the template here.