



Lichtblauw op tafel

v15296

Deze tafel is rijk aangekleed met lichtblauwe decoraties: papieren bloemen, ballonnen, tassels, servetten en manilla tags.

Hoe werkt het



1
Assemble the paper flowers as shown on the back of the packaging.

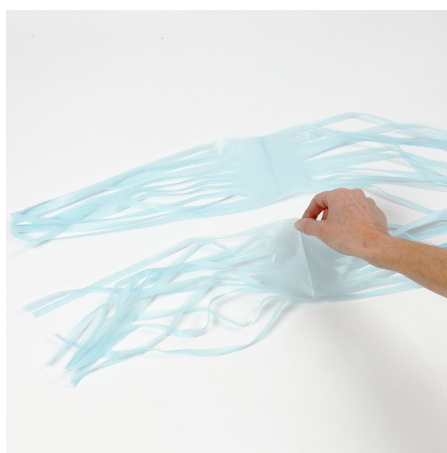

2
Put two tissue paper tassels together.



3
Fold them over each other.



4
Tie a ribbon in the middle. The ribbon must be long enough to be used for hanging and for attaching onto the balloon.



5
Fill the balloon with helium. Tie a knot and tie a ribbon onto the balloon.



6
Tie on the tassel.



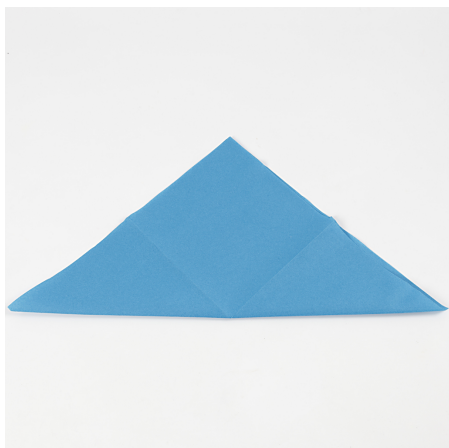

7
Unfold the napkin and then fold it in the middle as shown in the photo.

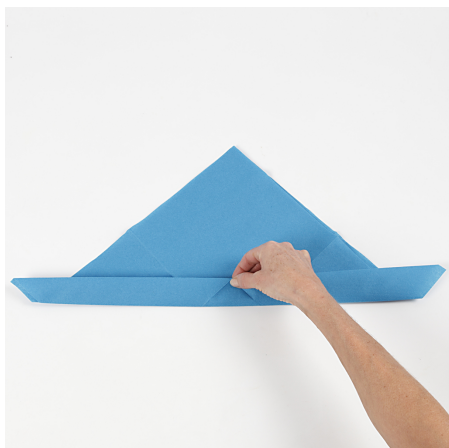

8
Fold the long end so that the fold is approx. 4.5 cm wide.



9
Turn over the napkin and bend one end towards you.

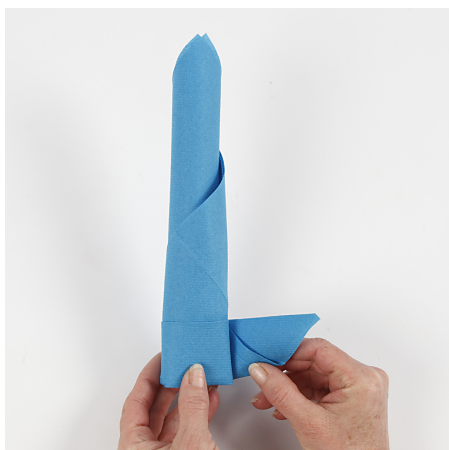

10
Roll the napkin to a tower.



11
Fold the end to secure the napkin and to hide the end.



12
Attach a paper clip with a bow for the finishing touch.



13
Write a name on manilla tags and use them for place cards. We recommend a black Uni Posca marker for manilla tags in pale colours and a white Uni Posca marker for dark coloured manilla tags. You may push a flower with a stalk onto the manilla tag for further decoration.